

## **CHHIMBU ACTIVE WOMEN GROUP**

**Bakanje-8, Solukhumbu**

**Date: 15th Nov.2010**

### **1) Name of Project: Water Flour Mill**

### **2) Short Information about the village;**

This Chhimbu is very backward in every aspect such as education, health and drinking water among 9 wards of Bakanje VDC. In this village most of the people from Thami community and very few of them are from Sherpa and Tamang community. Most of the people of this village are depending upon the agriculture and very few of them are depends upon Business and others. There are 146 people living in 24 houses. Among them 57 male, 48women and 43 are children. Among 43 children 26 go to school and 17 are living at their home.

### **3) Justifications of proposal;**

- a) The women of Bakanje 7 and 8 are using hand flour mill. Which takes long time as well as it is so hard to grind the seeds. So if there will be water flour mill then women could save their time and energy.
- b) All we are depend upon agriculture so the flour mill is most necessary for us. If there will be flour mill then we will care it properly and use for a long time.

### **4) Objectives of Project;**

- a) There will be good quality of flour grinded by flour mill as well as it will faster than now which save our time. Which makes our good health as well as we could use our time in some extra skilfully work.
- b) If we have enough time then we could give time for our children and sanitation.

### **5) Skilled Manpower for Project;**

There is some skilled person who could actively participate in the construction period. They are as follows according to their skill

- a) Machine installation:-Jangbu Sherpa
- b) For wall constructs:-Laxchu Thami
- c) Carpenter:- Laxchu Thami

## **6) Monitoring and supervising;**

Monitoring and supervising will be checked by the HIPRON and the selected persons of the committee of Women Group of Chhimbu. Who would check on following points;

- a) Accounting of project
- b) Work Evaluation
- c) Reporting to HIPRON

## **7) Expectation from HIPRON;**

We are expecting following materials from HIPRON side which are not available in the village are listed below

- a) Turbine of iron
- b) Zinc roof
- c) Pipe
- d) Cement
- e) Stone grinder

Note: Stone, sand and woods are available here but we are expecting financial support for it.

## **8) Activities;**

- a) We will legally transfer the land to women group which is going to donate by the Pasang Dorjee Sherpa of Chhimbu.
- b) Women group have Rs 10.000 from VDC. From which we will provide lunch to the worker during construction period.
- c) After using the mill we will charge some amount for its use and we will pay 50% to Budha Maya Thami as salary and 50% in the fund of mothers group. If Budha Maya will do better job than her salary will be increased.

## **9) Details of Project;**

We decided our project area for flour mill at Juke Pani stream of Bakange, Chhimbu. Nearby the Chhimbu Power House on the land of Pasang Dorjee Sherpa. Which land is going to donate for our flour mill. The project area is close to power house so, there is possibility to join water pipe in the main water pipe of power house to run turbine of mill. Which don't need more pipe to bring water. The water is bringing from Juke Pani Stream which is enough to produce electricity in dry seasons too. So, we also could run the mill in dry seasons. The source of this stream is Juke Pani and goes to Kinja River. Our flour mill would have Iron Turbine and Stone Grinder. The house of flour mill would have zinc roof, stone and mud wall, cemented floor,

having two windows small ground floor house. For the flour mill we don't need water tank to reserve water for dry seasons because there is already tank for power house made by wood having volume 60 litres. The benefits of flour mill to everyone of this village. Maximum time is only half hours to the women of Setay and Murmusay but for others only 5-15 minutes. Nowadays we have to go Ramechap or Orale. This takes Half day or full day for our turn to grind. Before 2 years ago there was small private flour mill but it damaged and not repaired.

**10) We include our expected budget for the project which is like these.**

- 1) All woods activities- Rs 20, 000.
- 2) 10 Pile stone including wages to worker- Rs 25,000.
- 3) 20 sacks sand including wages to worker - Rs 2,000.
- 4) 20 sack pebbles including wages to worker- Rs 2,000.
- 5) Wages for workers, 20 ManDays, to construct house (Rs 400 each) - Rs 8,000.
- 6) Stone Grinder –Rs 2,000.
- 7) Cement 5 sacks
- 8) Zinc roof and nails
- 9) Plastic Pipe
- 10) Iron Turbine etc. Should to bring from Kathmandu.

This project was written and presented by Mrs. Nisa Tamang,  
and it is translated by Miss Janaki Khadka

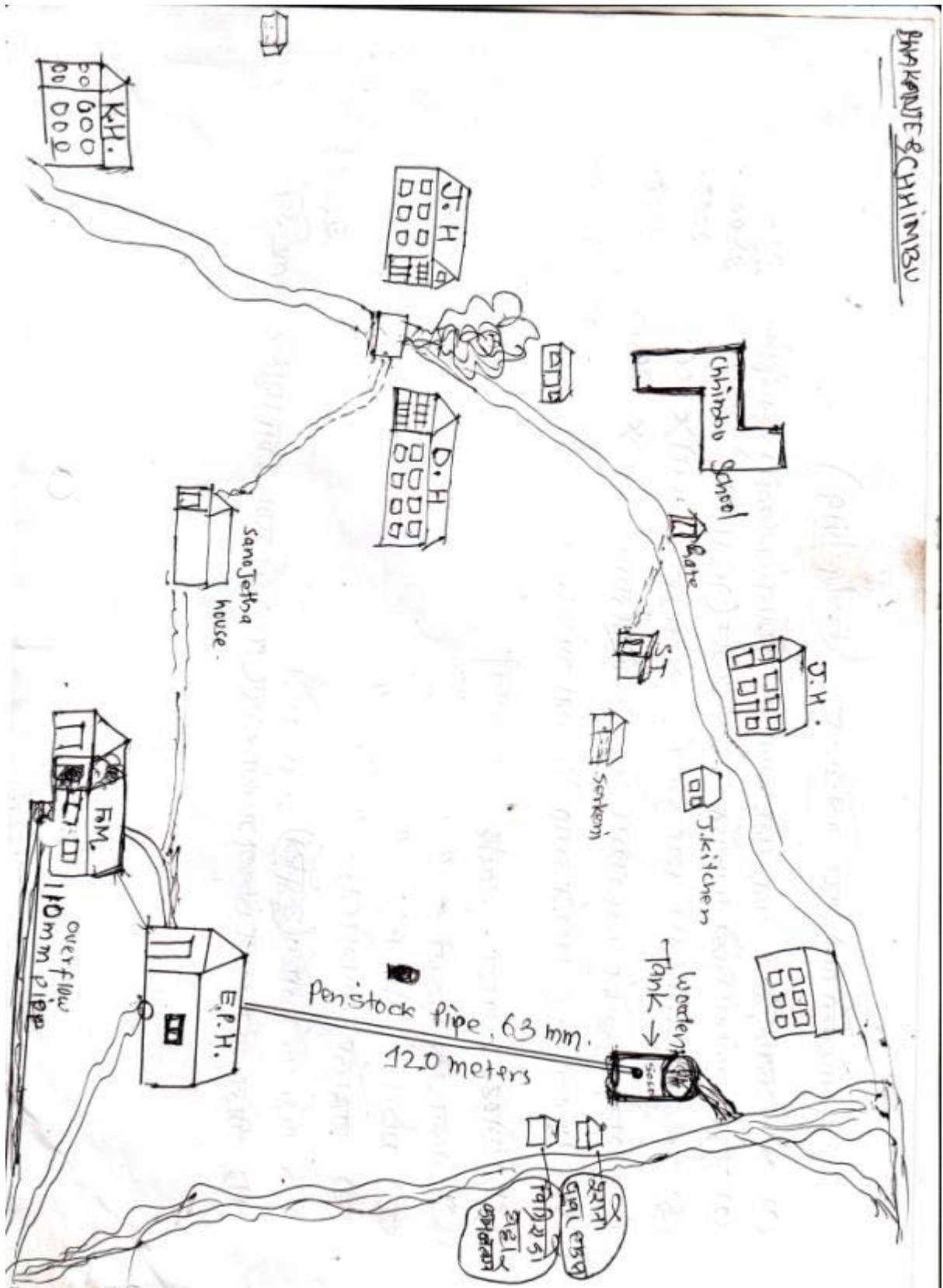

Simple map of Project Area for flour mill at Chhimbu

## **Conclusion by Papa Kurt:**

On the WEP meeting 15<sup>th</sup> November. 2010 following decisions was concluded:

The price of grinding flour will be 5 Rs per pathi (1 pathi = 4,4 liter)

To produce a proper pressure of the water hitting the turbine the supply pipe shall be of high quality (10 kg pressure) half way 63 mm internal measure and other half 40 mm and last half meter the pipe shall be 32 mm, added together with adaptor with washer and nut.

The outlet pipe shall be 110 mm and 4 kg pressure should be enough and 20 meter to go all the way down to the stream.

It was decided that Mother Group shall contribute:

- Up to 10.000 Rs for food for workers
- Transportation of stone and wood for construction site
- Digging fundament and channel
- Transportation of incoming materials from Bhandar

This will decrease the budget with 25.000 Rs and give the Mother Group a higher feeling of ownership of their own Flour Mill.

On 16<sup>th</sup> November 20.000 Rs was handed over to constructor Jangbu Sherpa from Himalayan Project as an advance payment. Turbine and pipe will be purchased in Kathmandu by HIPRON and send for Chhimbu by mid of December. Cement and tin plates will be purchased in Bhandar by constructor. The construction expenses will be presented to HIPRON as a full account by Mr. Jangbu Sherpa who will disburse the surplus amounts or delay payments, until the rest amount will be delivered by HIPRON at the first Runner Service after completing the project.

This is a wonderful project for the beautiful women of Chhimbu.